



www.willemachines.com

Performance beyond its size



ETS



www.willemachines.com

PERFORMANCE BEYOND ITS SIZE



The brand new Wille 275 Delta is the latest addition to the Wille Delta product family. This powerful machine designed for around-the-year use fits into tight spaces with ease and is packed full of new features to make your work easier.

Thanks to its low frame, the 275 Delta can fit into tight spaces and machine has excellent agility. The new frame structure is ideal for larger work attachments as well. Thanks to its low centre of gravity, the 275 Delta remains stable even on inclined surfaces, making it an excellent choice for cutting grass on gentle slopes, for example. The short front and rear overhangs make the 275 Delta easy to handle. The 275 Delta's wheelbase, which is slightly longer than that of the previous 275 model, stabilizes travel between locations and enables higher driving speeds.

The cabin has been completely redesigned with a focus on driving ergonomics and is extremely roomy for its size. Naturally, an air-cushioned seat, air conditioning and other familiar conveniences are available for the cabin. The user interface of the Wille 275 Delta has also been entirely revamped, and it is now easier than ever to monitor and control machine functions via the display.

The Wille 275 Delta is equipped with all the familiar features of the Delta series, such as customer-branded cover plating, Delta series smart features and the handrest control wheel which is found in larger machines and used to control the machine's user interface and functionalities.

In addition to familiar smart features, the Wille 275 Delta comes standard with the completely new Wille Smart Link fleet monitoring service, which allows you to keep track of your machine and monitor its status with ease.

PERFORMANCE BEYOND ITS SIZE

- ▶ **Versatile, high-performance hydraulics for a wide range of work attachments.**
- ▶ **Optional hydromechanical PTO, which enables front-mounted attachments that require mechanical power take-off.**
- ▶ **42 kW (56 hp) engine for exceptional performance for the machine size.**







WILLE **SMART** **LINK**

Wille Smart Link is a fleet management service designed for Wille environmental care machines, which allows you to easily monitor the status of the machine and plan work ahead. The information available to the driver is also available to other users with the help of a web browser-based interface.

USING WILLE SMART LINK YOU CAN:

- ▶ **Track the movements and location of the fleet in real time**
- ▶ **Monitor the efficiency, economy or historical data of machine use**
- ▶ **Saves reports on machine performance key figures (KPI)**
- ▶ **Anticipate and plan downtimes related to machine maintenance and service**

Along with the browser-based user interface, Wille Smart Link enables the open transfer of data produced by the machine through the interface also to possible external information systems already in use by customers. With the help of Wille Smart Link, the owner of the machine gets more and more accurate data about the work of the Wille environmental care machines, than with traditional retrofit monitoring devices.

MORE COMPREHENSIVE AND ACCURATE DATA:

- ▶ **About working**
- ▶ **Efficiency**
- ▶ **About the state and condition of the machine**
- ▶ **About consumption and emissions**

With the help of Wille Smart Link, the machine's maintenance network can also analyze the need for machine maintenance in problematic situations, as well as analyze possible problem points remotely, which shortens the service response time, which helps to minimize service interruptions caused by unexpected problems.

Wille Smart Link will be offered as a standard feature in all Wille models from the beginning of 2024. Its use is free for the duration of the machine's valid warranty, after which the owner of the machine can voluntarily continue using the system as an additional paid service.



SMARTER THAN EVER

In addition to Wille Smart Link, the Wille 275 Delta has other smart features familiar from previous Delta series machines that make the driver's work easier.



The precise Smart Cruiser cruise control optimised for work use operates using logic similar to a car's cruise control. It makes, for example, ploughing and brushing work easier and makes changing work locations more comfortable.



Smart Drive is a more ergonomic alternative to a creeping pedal. It uses software to convert the accelerator into a drive pedal: you can use the hand throttle to set the engine speed and only use the pedal to adjust the driving speed.



The Smart Flow feature adjusts the output of the motor hydraulics automatically based on machine speed. For example, it keeps the dispensing rate even regardless of varying driving speed during grit-tin.



With the Smart Lube system, which is available as an option, the driver can select the lubrication output of the central lubrication system from four preset settings. Selecting the correct supply rate prevents excessive lubrication.



PERFORMANCE BEYOND ITS SIZE

Metric Measurements

ENGINE

- ▶ Kohler KDI 1903TCR EPA
- ▶ 3 cylinder turbo charged and intercooled diesel engine
- ▶ DOC and DPF
- ▶ Common Rail fuel system
- ▶ Engine displacement 1861 cm³
- ▶ Output 42 kW (56 hp)/2600 rpm
- ▶ Max. torque 225 Nm/1500 rpm
- ▶ Fuel tank 50 l

ELECTRIC SYSTEM

- ▶ Voltage 12 V
- ▶ Electric main switch
- ▶ Battery 85 Ah
- ▶ Starter motor 2,2 kW
- ▶ Charger 100 A

TRANSMISSION

- ▶ Hydrostatic, electronically controlled
 - Variable displacement pump
 - 2-speed wheel motors
- ▶ Four wheel drive
- ▶ Electric direction change forwards and backwards
- ▶ Two (electrohydraulically controlled) speed ranges
- ▶ Driving speed
 - 0-20 km/h
 - 0-40 km/h
- ▶ Joystick activated hydraulic differential lock
- ▶ Hydraulically assisted multi-disc brakes in oil-bath in the front
- ▶ Automatic parking brake

WEIGHTS

- ▶ Own weight 2180 kg
- ▶ Front axle weight 1000 kg
- ▶ Rear axle weight 1180 kg

STEERING SYSTEM

- ▶ Hydrostatic articulated frame steering
- ▶ Turn angle +/- 45°
- ▶ Tilt angle +/- 7.5°

WORK HYDRAULICS

- ▶ Gear pump 55 l/min
- ▶ Gear pump 35 l/min
- ▶ Gear pump 20 l/min
- ▶ Max motorhydraulic flow 110 l/min
- ▶ Max pressure of the hydraulic system 200 bar
- ▶ Volume of hydraulic system about 60 l
- ▶ Hydraulic oil cooler

FRONT HITCH

- ▶ 3 point Cat 1
- ▶ Lifting arms mechanical float
- ▶ Automatic suspension 4-10 km/h
- ▶ Float position
- ▶ Hydraulic pilot control
- ▶ Lifting force
 - Lower position 13 kN
 - Upper position 12 kN
- ▶ Lifting height 650 mm

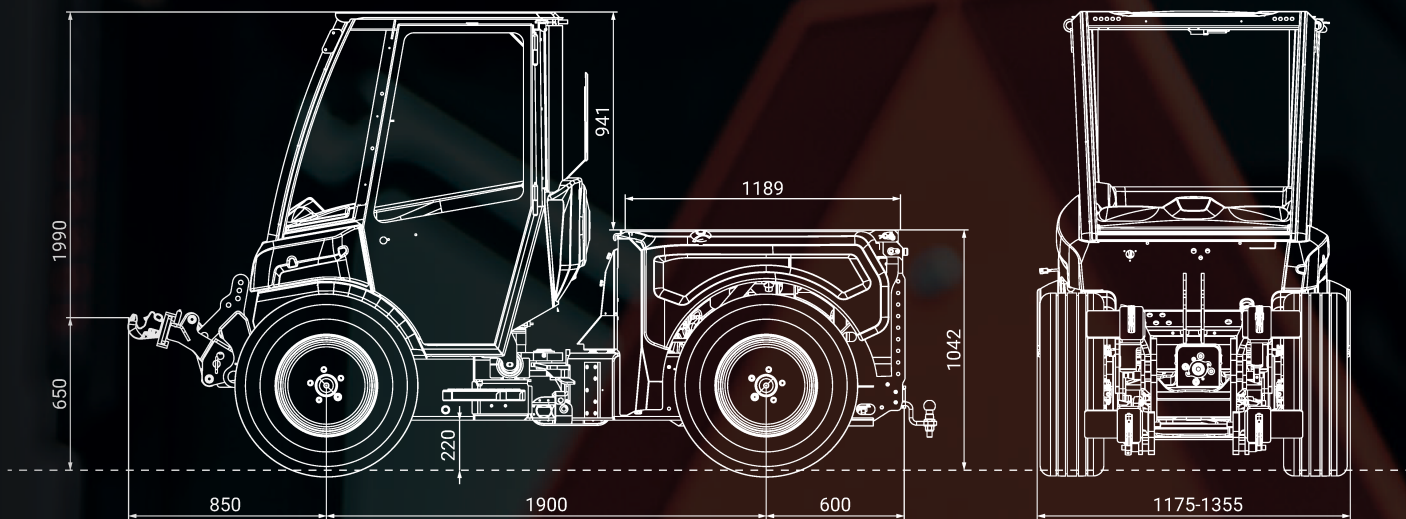

► Width **1175 / 1355 mm** ► Height **1990 mm** ► Length **3350 mm** ► Weight **2180 kg**

Metric Measurements

TIRES

- 265/70R16 (width of the machine 1355 mm)
- 205/80R16 (width of the machine 1175 mm)

STANDARD EQUIPMENT

- Electric inching and accelerator pedal
- Speed adjusted motor hydraulics (Smart Flow)
- 4.3" screen
- Radio/Bluetooth/AUX-in/USB
- Windscreen and rear window wiper and washer
- Heated rear-view mirrors
- LED work lights in the front and the rear
- Height adjustable steering wheel
- Heated seat
- 2-point seatbelt
- Additional rear lights in upper corners of cab
- 3 different driving modes: Transport, Heavy Duty, Smart Drive
- Smart Cruiser cruise control
- Bottom plates in the front and the rear
- Tow hitch
- Reverse alarm
(can be connected on/off by operator)
- Brackets for work attachments on top of the engine compartment

OPTIONAL EQUIPMENT

- Hydraulic adjustment of lifting arms
- Hydromechanical PTO
- 5th cylinder hydraulics front
- Hydraulic oil heater
- Smart Lube central lubrication
- Joint stabilizer
- Extra dual-acting rear cylinder hydraulics
- Hydraulic tiltable platform
- Manual air conditioning
- Air-cushioned seat with 3-point seatbelt
- LED headlights
- 2 + 2 LED additional work lights
- 8 pcs LED warning lights
- Special colour
- Accessory bar

WILLE OPTIM WORK ATTACHMENTS

- Several different work equipment available,
ask your Wille salesperson for more!



PERFORMANCE BEYOND ITS SIZE

Imperial Measurements

ENGINE

- ▶ Kohler KDI 1903TCR EPA
- ▶ 3 cylinder turbo charged and intercooled diesel engine
- ▶ DOC and DPF
- ▶ Common Rail fuel system
- ▶ Engine displacement 1861 cc
- ▶ Output 42 kW (56 hp)/2600 rpm
- ▶ Max. torque 166 ft-lbs/1500 rpm
- ▶ Fuel tank 13.2 gal

ELECTRIC SYSTEM

- ▶ Voltage 12 V
- ▶ Electric main switch
- ▶ Battery 85 Ah
- ▶ Starter motor 2,2 kW
- ▶ Charger 100 A

TRANSMISSION

- ▶ Hydrostatic, electronically controlled
 - Variable displacement pump
 - 2-speed wheel motors
- ▶ Four wheel drive
- ▶ Electric direction change forwards and backwards
- ▶ Two (electrohydraulically controlled) speed ranges
- ▶ Driving speed
 - 0-12.5 mph
 - 0-25 mph
- ▶ Joystick activated hydraulic differential lock
- ▶ Hydraulically assisted multi-disc brakes in oil-bath in the front
- ▶ Automatic parking brake

WEIGHTS

- ▶ Own weight 4800 lbs
- ▶ Front axle weight 2200 lbs
- ▶ Rear axle weight 2600 lbs

STEERING SYSTEM

- ▶ Hydrostatic articulated frame steering
- ▶ Turn angle +/- 45°
- ▶ Tilt angle +/- 7.5°

WORK HYDRAULICS

- ▶ Gear pump 14.5 gpm
- ▶ Gear pump 9.3 gpm
- ▶ Gear pump 5.3 gpm
- ▶ Max motorhydraulic flow 29 gpm
- ▶ Max pressure of the hydraulic system 2900 psi
- ▶ Volume of hydraulic system approx. 16 USgal
- ▶ Hydraulic oil cooler

FRONT HITCH

- ▶ 3 point Cat 1
- ▶ Lifting arms mechanical float
- ▶ Automatic suspension 2.5-6 mph
- ▶ Float position
- ▶ Hydraulic pilot control
- ▶ Lifting force
 - Lower position 2900 lbs
 - Upper position 2700 lbs
- ▶ Lifting height 25.6"

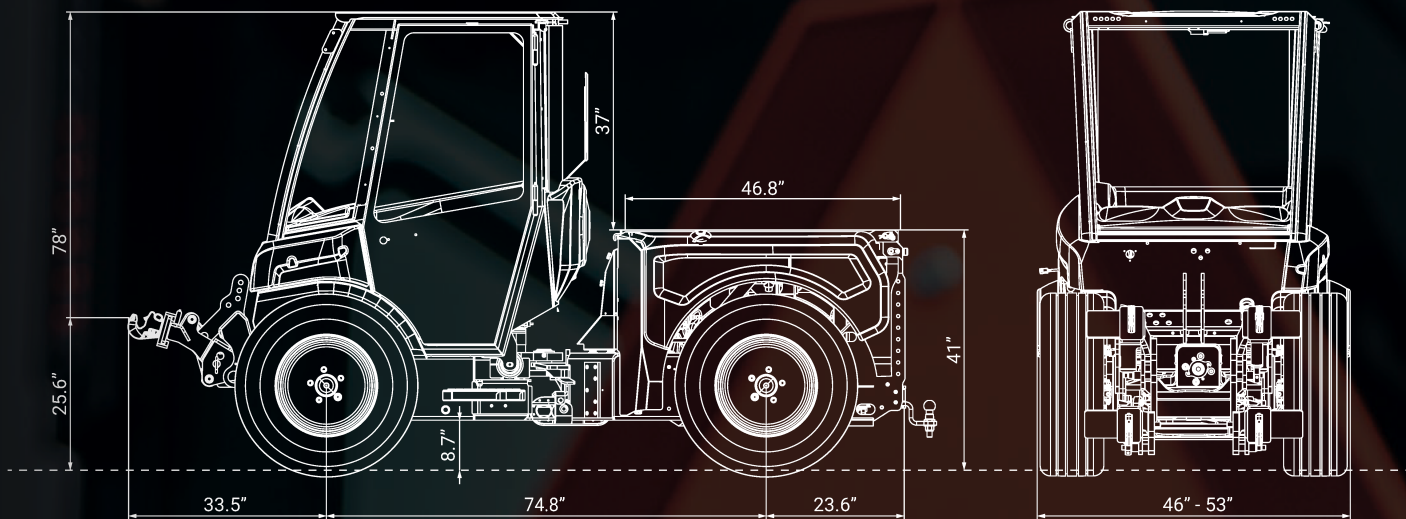

► Width **46" / 53"** ► Height **78"** ► Length **132"** ► Weight **4800 lbs**

Imperial Measurements

TIRES

- 265/70R16 (width of the machine 53")
- 205/80R16 (width of the machine 46")

STANDARD EQUIPMENT

- Electric inching and accelerator pedal
- Speed adjusted motor hydraulics (Smart Flow)
- 4.3" screen
- Radio/Bluetooth/AUX-in/USB
- Windscreen and rear window wiper and washer
- Heated rear-view mirrors
- LED work lights in the front and the rear
- Height adjustable steering wheel
- Heated seat
- 2-point seatbelt
- Additional rear lights in upper corners of cab
- 3 different driving modes: Transport, Heavy Duty, Smart Drive
- Smart Cruiser cruise control
- Bottom plates in the front and the rear
- Tow hitch
- Reverse alarm
(can be connected on/off by operator)
- Brackets for work attachments on top of the engine compartment

OPTIONAL EQUIPMENT

- Hydraulic adjustment of lifting arms
- Hydromechanical PTO
- 5th cylinder hydraulics front
- Hydraulic oil heater
- Smart Lube central lubrication
- Joint stabilizer
- Extra dual-acting rear cylinder hydraulics
- Hydraulic tiltable platform
- Manual air conditioning
- Air-cushioned seat with 3-point seatbelt
- LED headlights
- 2 + 2 LED additional work lights
- 8 pcs LED warning lights
- Special colour
- Accessory bar

WILLE OPTIM WORK ATTACHMENTS

- Several different work equipment available,
ask your Wille salesperson for more!



WILLE 375Δ

AMAZINGLY VERSATILE AND AGILE

www.willemachines.com

LRQA
CERTIFIED

ISO 9001 • ISO 14001

WILLE 375Δ

AMAZINGLY VERSATILE

WILLE'S BENEFITS COMPARED TO A TRADITIONAL LOADER

- ▶ Wille loaders are versatile and the wide variety of accessories ensures that they can be used through all four seasons
- ▶ Wille's transport speed makes moving between locations a breeze
- ▶ Wille Wille can also fit into cramped spaces, such as under low bridges and in underpasses
- ▶ Wille's cab has great visibility in all directions, especially around the attachments and their working area
- ▶ Wille provides excellent ergonomics, and the cabin is easy to enter and exit



A front loader with extensive outreach, hydraulic flow sufficient for multiple work attachments and a wide range of optional equipment available are features that make the Wille 375Δ amazingly versatile: with one single machine, you can achieve more than with a mini-tractor or a wheel loader of the same size.

The front loader included as standard ensures that you have the reach to lift loads up high. Thanks to

the machine's powerful hydraulic system, you can use a variety of attachments simultaneously. This makes work efficient and reduces time and effort spent moving the loader between locations. The range of compatible attachments is wide, and suitable Wille Optim attachments that have been optimized for Wille loaders are available for every season.

This agile machine intended for maintaining street and green areas features the Delta series smart

AND AGILE

WILLE'S BENEFITS COMPARED TO A MINI-TRACTOR:

- ▶ Wille's articulated steering makes it an agile and versatile workhorse for all seasons
- ▶ Thanks to the ergonomics, visibility from the cab is great and the attachment and work areas can be easily monitored
- ▶ Wille machines come with a front loader integrated into the frame structure as standard.



functions, which improve usability. The clear display for hydraulic functions and the motor hydraulics that are adjusted according to driving speed make the attachments easy to use in all work phases.

Working with an access platform is safe and easy: the machine prevents driving automatically when the platform is in operation. The extra rear lights in the top rear corners increase safety and comfort when using large attachments.

WILLE IS ALSO AVAILABLE IN TRACTOR VERSION



As an option, the Wille 375Δ is also available with EU tractor type approval.

Contact our sales personnel for more information!

FIRST-RATE TECHNOLOGY

The Wille 375Δ model now makes using attachments easier than ever: the display shows how the output of the hydraulic pumps is routed to the various attachments. The clear display also indicates any problems and malfunctions.

AUTOMATIC ECO DRIVE

The machine comes as standard with the Automatic Eco Drive feature, which reduces fuel consumption and noise. It lowers engine speed automatically as needed, saving fuel and reducing emissions.

SMART DRIVE

Smart Drive is a more ergonomic alternative to a creeping pedal. It uses software to convert the accelerator into a drive pedal: you can use the hand throttle to set the engine speed and only use the pedal to adjust the driving speed.

SMART FLOW

The Smart Flow feature adjust the output of the motor hydraulics automatically based on machine speed. For example, it keeps the dispensing rate even regardless of varying driving speed during gritting.

SMART LUBE

With the Smart Lube system, which is available as an option, the driver can select the lubrication output of the central lubrication system from four preset settings. Selecting the correct supply rate prevents excessive lubrication.

The Wille 375Δ features Stage V emission class 42 kW Kohler diesel motor. It is also possible to use 100% HVO biodiesel as the fuel, thereby significantly reducing the carbon footprint.

The Wille Anti-Theft System, which is available as an option, provides Wille owners and drivers with security by preventing unauthorized ignition.

ACCESSORIES 375Δ

- 1. Rear tilt
- 2. Rear view camera
- 3. Multifaster
- 4. LED warning lights
- 5. Special color - the cladding color can be selected from an RAL color chart to match the customer's branding.

Other accessories include air conditioning, ignition prevention, air-cushioned seat, LED headlights and additional work lights.

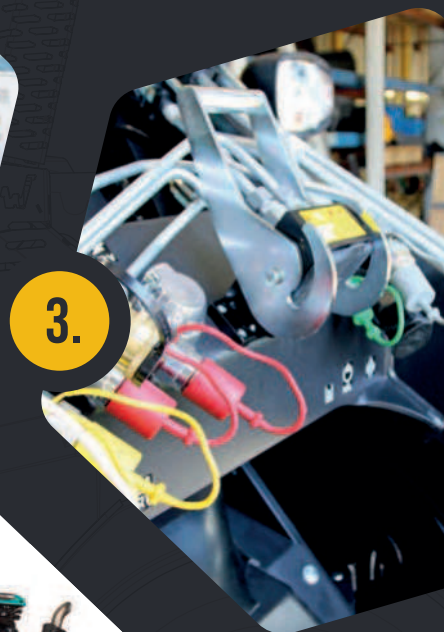

WILLE

375Δ

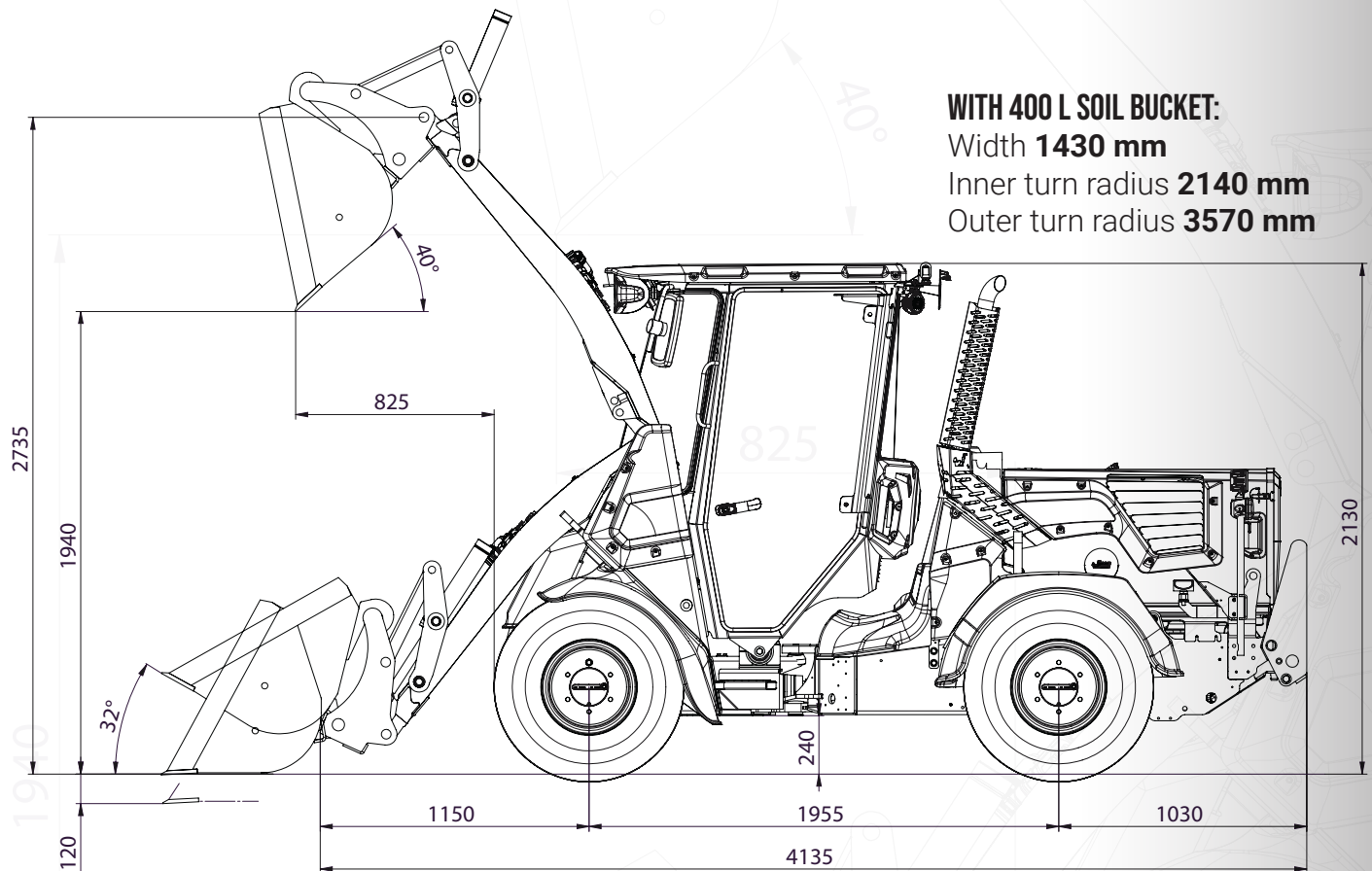

WITH 400 L SOIL BUCKET:

Width **1430 mm**

Inner turn radius **2140 mm**

Outer turn radius **3570 mm**

ENGINE

- Kohler KDI1903TCR EU Off Road Stage 5
- 3 cylinder turbo charged and intercooled diesel engine
- DOC and DPF
- Common Rail fuel system
- Displacement 1861 cm³
- Output 42 kW (56 hp)/2600 rpm
- Max. torque 225 Nm/1500 rpm
- Fuel tank 50 l

ELECTRIC SYSTEM

- Voltage 12 V
- Electric main switch
- Battery 100 Ah
- Start motor 2.2 kW
- Alternator 100 A

TRANSMISSION

- Hydrostatic transmission
 - Variable displacement pump
 - Variable displacement motor
- Driving direction to the front and rear is changed electrically

- 1-nopeuksinen alennusvaihte

- Driving speed/tractive force 0–38 km/h/1500 daN

NOISE LEVEL

- Outside cabin under LwA 101 dBA (ISO 6395:2008)
- Inside cabin under LpA 72 dBA (ISO 6396:2008)

WEIGHT

- Own weight 2960 kg
- Front axle weight 1330 kg
- Rear axle weight 1630 kg

STEERING SYSTEM

- Hydrostatic articulated steering
- Turning angle +/- 39°
- Angle of oscillation +/- 7°

AXLES

- Automatic differential locks in the front
- Hydraulically assisted multi-disc brakes in oil-bath in the front
- Electrohydraulic parking brake control

OPERATING HYDRAULICS

- Gear pump 55 l/min, 200 bar
- Gear pump 35 l/min, 200 bar
- Gear pump 20 l/min, 200 bar
- Volume of hydraulic system about 60 l
- Hydraulic oil cooler

FRONT HITCH

- Quick coupler options: Kunta 500, Vila and Trima
- Mechanic quick-coupler for work attachment
- Hydraulic stabilizer system
- Automatic loader suspension 5-10 km/h
- Hydraulic suspension
- Hydraulic pilot control
- Arm maintenance support
- Arm support for bulldozing

TYRES

- 32x11,5-15 (width of the machine 1430 mm)
- With lawn tyres 31x15,5-15 (width of the machine 1520 mm)

STANDARD EQUIPMENT

- Motor hydraulic pumps (max flow 2600 rpm)
 - two-way forward 0-55 l/min
 - single-acting to the front 110 l/min
 - single-acting to the rear 110 l/min
- Hydraulic circuit for 3rd cylinder
- Hydraulic circuit for 4th cylinder
- Double-acting cylinder hydraulics to the rear
- Electric inching and accelerator pedal
- Electrical stepless hand throttle
- High-pressure water hose
- Headlight automation
- Motor hydraulics output adjusted according to driving speed
- Motor hydraulics output displayed on screen
- Additional rear lights at the top corners of the cab
- Flow control valve for motor hydraulics with electric control 0-55 l/min
- Socket outlet of 12 V in the front and rear
- Cab features a beacon light with foldable shaft
- TFT display
- Radio/Bluetooth/AUX-in/USB
- Windscreen and rear window wiper and washer
- Rear mirrors with heating
- Led work lights in the front and rear
- Adjustment of steering wheel tilt
- Seat with heating
- 2-point safety belt
- Sun roof
- Safety cabin ROPS (ISO 3471)
- Safety cabin FOPS (ISO 3449 1365 J)

- Engine heater
- Bottom armours in the front and rear
- Towing hitch
- Reverse alarm (can be connected on/off by operator)
- Immobiliser is active when the parking brake is engaged
- Brackets for work attachments on top of the engine compartment

OPTIONAL EQUIPMENT

- Rear tilt (Kunta 500, Vila ja Trima)
- Float position of rear tilt
- Smart Lube central lubrication
- Extra cooler for hydraulic oil
- Hydraulic oil heater
- LED headlights
- Anti-Theft System
- 8 LED warning lights
- Air-conditioning
- Air-cushioned seat
- Readiness for cabin heater
- Rear view camera
- Special color
- 2 + 2 LED additional work lights
- Multifaster
- Left-side armrest
- LED warning lights for the machine's rear light posts
- Shortwave radio
- Breathalyzer lock
- Smartphone holder
- Battery charger kit
- Lowered cab
- Equipped for the Zoom plow
- Equipped for the Wille 9 access platform
- Equipped for the horizontal cutter
- EU tractor type approval
- Tire sets (lawn tire)

WILLE WORK ATTACHMENTS:

- Rotary brush 170
- Collecting sweeper 205
- Ice-plough
- Soil bucket 400 l
- Snow bucket 800 l
- High-tipping bucket 550 l
- Multi-function bucket 750 l
- Rear sand spreader 250 l
- Leaf collector 900 l
- High-pressure washer 550 l
- Sprinkling tank 550 l
- Fixed platform 230 l
- Access platform Wille 9

	Front face of the quick coupler	Soil bucket 400 L	Forklift fork with 500 mm distance to center of gravity
Hydraulic lifting force, bottom position kN	17,7	16,2	14,8
Hydraulic lifting force, top position kN	7,4	5,8	5,1
Rated transport capacity kg		625*	850* (even surface)
Tipping load with straight/turned machine kg	1720/1510*	1500/1250*	1250/1070*
Break-out force of the bucket kN		10,0	

*With rear tilt, without counterweight. According to standards ISO 8313 and EN 474-3.



WILLE 475Δ

COMPACT POWER

www.willemachines.com

LRQA
CERTIFIED

ISO 9001 • ISO 14001

WILLE 475Δ

COMPACT

The Wille 475Δ is the most popular multi-function machine in its size class and the most controllable such product on the market. The driver is at the centre of the design and there are plenty of technical features. Even though the 475Δ is a compact size, it has features usually found only in larger machines.

Thanks to its articulated frame steering and compact size, the 475Δ is nimble when driven. The cab of the machine sits on the front frame, making the machine low, and the cab can follow the work device. Work devices can be mounted on the loader, on top of the bonnet or on the back tilter, which makes it possible to perform several jobs at once. Thanks to its versatile work devices, the machine can be used all year round. Unlike with wheel loaders, the excellent weight distribution of Wille holds the machine steady even when using the back tilter. The 40 km/h top speed is also the highest in the size range.

One of the most important technical innovations is the electrically controlled loader valve and drive transmission.

The driver can adjust the movement speed of the loader according to their preference, and can save values for different work devices. The new, precise cruise control makes working easy and reliable.

Completely new cab

The cab of the Wille 475Δ is completely new and significantly roomier than for previous models. Thanks to the glass door and arching windscreen, visibility is excellent, both to the ground and up to the maximum height of the arms.

**WILLE IS ALSO AVAILABLE
IN TRACTOR VERSION**



As an option, the Wille 475Δ is also available with EU tractor type approval.

Contact our sales personnel for more information!



POWER

The low dashboard improves visibility to the work device and frees up knee space for the driver. Thanks to the steering wheel, which can be adjusted both depth- and height-wise, every driver can easily find an ergonomic driving position. The comfort of the cab is completed by its silence and long list of optional extras.

The new user interface makes work easier for the driver. The easy-to-use interface is operated using a scroll wheel and shortcut keys, which have been positioned with-

in reach of the driver's right hand and are there to make work easier and more efficient. There are 30 programmable work device and driver profiles available, which allow for correct and cost-efficient operation of the work device.

The user interface also includes safety features, such as warnings about incorrect use, user instructions for the driver and maintenance reminders. The safety and visibility of the machine can be maximised with the eight warning beacons and the four waist beacons available as optional extras.

Thanks to the electronically controlled loader, the driver can adjust the functions of the work device and hydraulics. The driver can programme the joystick operations according to their preferences and create work profiles for different work devices.

In addition, the machine has adjustable bucket shake.



FIRST-CLASS TECHNOLOGY

The Wille 475Δ has a stage V emission class, 55kW Kohler diesel engine equipped with particle filter and catalytic converter. The fuel used can be 100% HVO biodiesel, which significantly decreases the carbon footprint.



**AUTOMATIC
ECO DRIVE**

The machine comes as standard with the Automatic Eco Drive feature, which reduces fuel consumption and noise. It lowers engine speed automatically as needed, saving fuel and reducing emissions.

Käyttöprofiilit

SMART DRIVE

Smart Drive is a more ergonomic alternative to a creeping pedal. It uses software to convert the accelerator into a drive pedal: you can use the hand throttle to set the engine speed and only use the pedal to adjust the driving speed.

SMART CRUISER

000031 h

The precise Smart Cruiser cruise control optimised for work use operates using logic similar to a car's cruise control. It makes, for example, ploughing and brushing work easier and makes changing work locations more comfortable.

SMART FLOW

The Smart Flow feature adjusts the output of the motor hydraulics automatically based on machine speed. For example, it keeps the dispensing rate even regardless of varying driving speed during gritting.

SMART LUBE

With the Smart Lube system, which is available as an option, the driver can select the lubrication output of the central lubrication system from four preset settings. Selecting the correct supply rate prevents excessive lubrication.



In Soft Drive mode, the gas pedal of the Wille operates more precisely, which makes the Wille more stable and easier to control for tasks requiring precision. Soft Drive mode is ideal for using forklift lifting forks, for example.

ACCESSORIES 475Δ

- 1. Back tilter
- 2. Storage box
- 3. Cup holder
- 4. Reverse camera
- 5. Special colour
- 6. Multifaster
- 7. LED warning lights

Additional options include:
air conditioning, immobiliser,
air-cushioned seat,
LED work lights
and LED additional work lights.

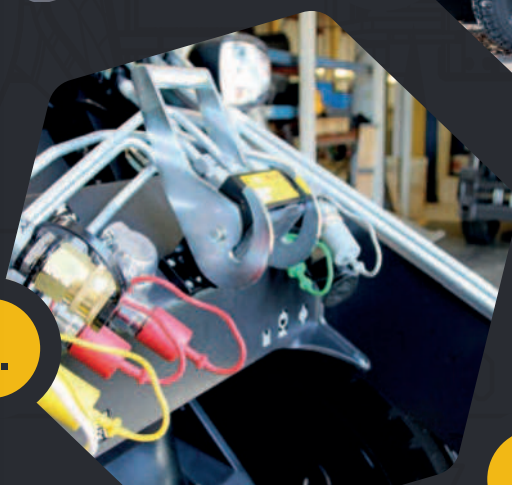

WILLE

475Δ

WITH 600 L SOIL BUCKET:

Width **1640 mm**

Inner turn radius **2285 mm**

Outer turn radius **3925 mm**

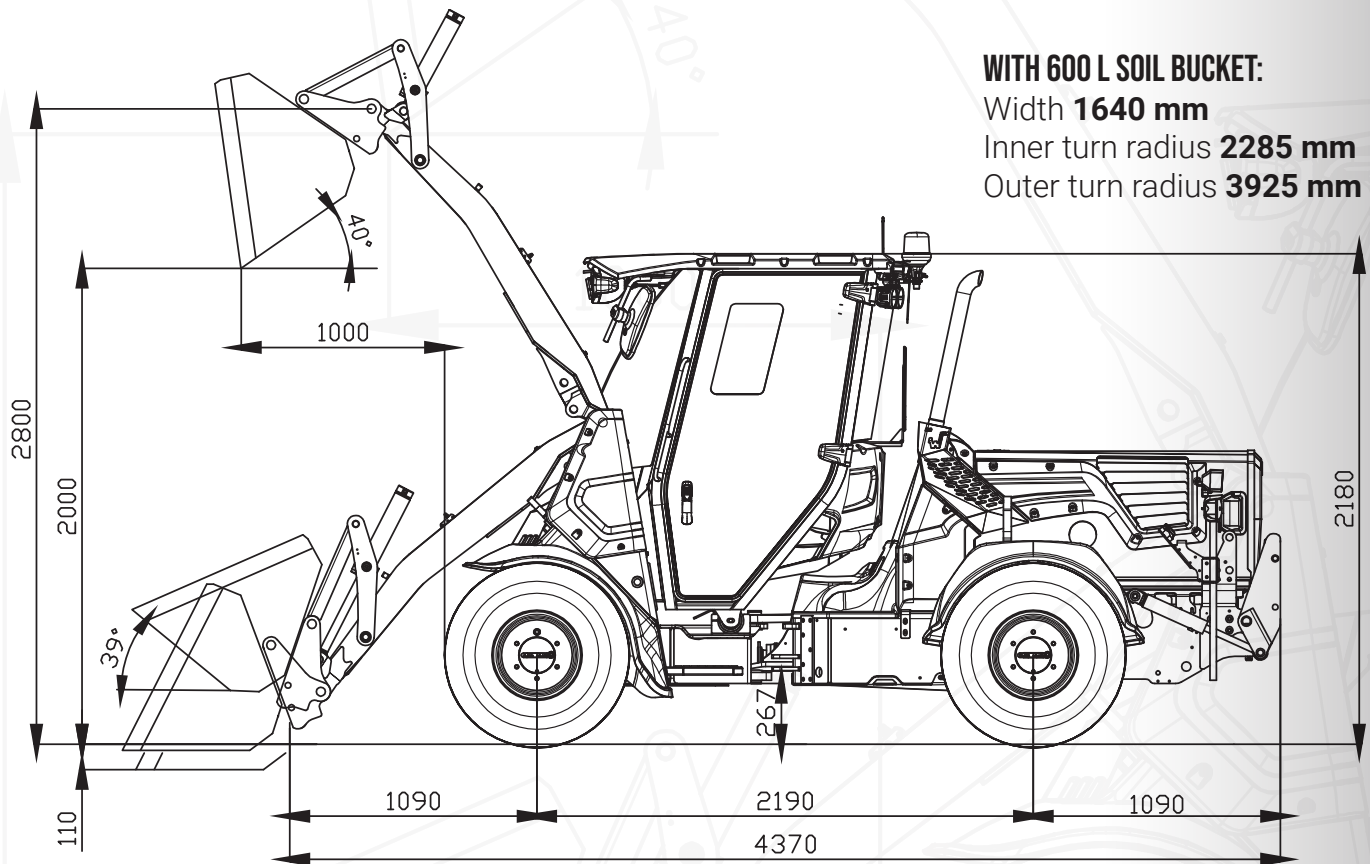

ENGINE

- Kohler KDI 2504 TCR, EU Off Road Stage 5
- 4 cylinder turbo charged and intercooled diesel engine
- DOC and DPF
- Common Rail fuel system
- Engine displacement 2482 cm³
- Output 55,4 kW (74,3 hv)/2300 rpm
- Max. torque 300 Nm/1500 rpm
- Fuel tank 50 l

ELECTRIC SYSTEM

- Voltage 12 V
- Electric main switch
- Battery 105 Ah
- Starter motor 2,0 kW
- Charger 100 A

TRANSMISSION

- Hydrostatic, electronically controlled
 - Variable displacement pump
 - Variable displacement engine
- Electric direction change forwards and backwards

- 1-speed reduction gear

- Driving speed/tractive force 0-40 km/h/1600 daN

NOISE LEVELS

- Outside cabin under LwA 101 dBA (ISO 6395:2008)
- Inside cabin under Lpa 69 dBA (ISO 6396:2008)

WEIGHTS

- Total 3550 kg
- Front axle weight 1640 kg
- Rear axle weight 1910 kg

STEERING SYSTEM

- Hydrostatic articulated frame steering
- Turn angle +/- 40°
- Tilt angle +/- 9°

AXLES

- Automatic friction locks in the front
- Hydraulically assisted multi-disc brakes in oil-bath in the front
- Automatic parking brake

WORK HYDRAULICS

- Load-detecting variable displacement pump 80 l/min, 200 bar
- Gear pump 50 l/min, 200 bar
- Engine hydraulics maximum output 130 l/min, 200 bar
- Hydraulic system capacity ca. 70 l
- Hydraulic oil cooler

FRONT LOADER

- Quick coupler options: Kunta 500, Vila and Trima
- Hydraulic work device quick locking
- Hydraulic stabiliser
- Automatic loader suspension 4-10 km/h
- Electric pre-steering
- Arm maintenance support
- Arm support for bulldozing

TYRES

- 305/70R16 (machine width 1640 mm)
- 380/60R15 grass tyres (machine width 1830 mm)

STANDARD EQUIPMENT

- Engine hydraulics (max output 2300 rpm)
 - two-way front 0–80 l/min
 - one-way front 50 l/min
 - one-way front 50–130 l/min
 - one-way rear 50/0–80/50–130 l/min
- 3rd cylinder hydraulics, propo controlled
- 4rd cylinder hydraulics, propo controlled
- Dual-acting cylinder hydraulics rear
- Electric inching and accelerator pedal
- Speed adjusted motor hydraulics
- Socket outlet of 12 V in the front and the rear
- Lowerable LED warning beacon
- 7" display
- Radio/Bluetooth/AUX-in/USB
- Windscreen and rear window wiper and washer
- Heated rear-view mirrors
- Automatic headlights
- LED work lights in the front and the rear
- Height and depth-adjustable steering wheel
- Heated seat
- 2-point seatbelt
- Additional rear lights in upper corners of cab
- Programmable work device and driver profiles
- 4 different driving modes: Eco, Eco Off, Soft Drive and Smart Drive
- Smart Cruiser cruise control
- Safety cabin ROPS (ISO 3471)

- Safety cabin FOPS (ISO 3449 1365 J)
- Engine heater
- Bottom plates in the front and the rear
- Tow hitch
- Reverse alarm (can be connected on/off by operator)
- Brackets for work attachments on top of the engine compartment

OPTIONAL EQUIPMENT

- Back tilter: Kunta 500, Vila and Trima
- Back tilter float position
- Hydraulic oil heater
- Smart Lube central lubrication
- Automatic air conditioning
- Air-cushioned seat with 3-point seatbelt
- Internal heater ready
- Storage box for cab
- Rear view camera
- 2 + 2 LED additional work lights
- 8 pcs LED warning lights
- 4 pcs LED waist beacons
- Trailer brake valve
- Multifaster
- Special colour
- Immobiliser
- Eberspächer fuel heater
- Anti-Theft System
- Roller blind
- Accessory bar
- Cup holder
- Heated windscreen

WILLE OPTIM WORK ATTACHMENTS

- Rotary brush 200
- Collecting sweeper 305
- Ice-plough
- Soil bucket 600 l
- Snow bucket 1200 l
- High-tipping bucket 800 l
- Multi-function bucket 1000 l
- Leaf bucket 1200 l
- Hydraulic rear blade 1800
- Rear sand spreader 370 l
- Disc spreader 700 l
- Leaf collector 1000 l
- High-pressure washer 1000 l
- Platform 270 l
- Hydraulic platform 300 l
- Access platform Wille 9

	Front face of the quick coupler	Soil bucket 600 L	Forklift fork with 500 mm distance to center of gravity
Hydraulic lifting force, bottom position kN	24,7	23,0	19,5
Hydraulic lifting force, top position kN	11,6	10,3	9,5
Rated transport capacity kg		1005*	1090* (even surface)
Tipping load with straight/turned machine kg	2530/2270*	2170/2010*	1700/1370*
Break-out force of the bucket kN		16,4	

*With back tilter and without counterweight. Tipping loads measured in accordance with standard ISO 14397.



WILLE 675Δ 875Δ

YOUR YEAR-ROUND WORK MACHINE

www.willemachines.com

LRQA
CERTIFIED

ISO 9001 • ISO 14001

WILLE 675Δ 875Δ

YOUR YEAR-ROUND WORK MACHINE

The delta series combines versatile use, quality and intelligence. The design of the series emphasized features that improve driver comfort and work efficiency to ensure consistent work quality and help the driver focus on what matters.

Unbeatable in its weight class, the 675Δ is nimble even in tight locations and safe in busy areas thanks to the features that help the driver stay aware of the surroundings. The Wille 875Δ is a gentle giant of environmental management, boasting a spacious and quiet cab that ensures the driver's comfort even in heavy duty tasks. The 875Δ is the largest Wille machine ever made, but its movements are very smooth.

Thanks to the articulated steering, even the large

er Wille machines are agile, and the smart driving modes improve the handling even further. The cab is situated on the frame, which is why the machine sits low and the cab follows the machine. Work attachments can be installed on the front loader, hood and rear tilt mechanism for handling multiple work tasks at once. The versatile attachments ensure that the machine can be used through the year. In contrast to wheel loaders, Wille's excellent weight distribution keeps the machine stable even when using the rear tilt. The 50 km/h top speed is at the top of the weight class!

Among the most important technical updates is the electrically controlled loader valve and drive power train. The driver can adjust the loader's movement speeds and save the desired values for different work attachments. With the new precise cruise control, you can handle many work tasks easily and reliably.

Driver-centric approach

The cab has been updated, and it is now much more spacious and quiet than before. The glass door and the sloping windshield provide excellent visibility of the surrounding area below and up all the way to the maximum height of the arms.

The low dashboard improves visibility of the work attachment and provides more knee room for the driver. Thanks to the steering wheel with

**WILLE IS ALSO AVAILABLE
IN TRACTOR VERSION**



As an option, the Wille 675Δ and 875Δ are also available with EU tractor type approval.

Contact our sales personnel for more information!



**THE DRIVER HAS EXCELLENT
VISIBILITY OF THE SURROUNDINGS
AND THE WORK ATTACHMENT.**



**THANKS TO THE USER INTERFACE,
THE DRIVER CAN SEE THE OUTPUT
OF THE MOTOR HYDRAULICS IN
REAL TIME AND PROGRAM IT
TO BE OPTIMAL FOR EACH
WORK ATTACHMENT.**



adjustable depth and height, every driver can easily find an ergonomic driving position. The cab is also impeccably quiet and the comfort is further improved by a wide range of accessories, such as a heated windshield and joystick control.

In the Delta series cab, all controls are at your fingertips and can be programmed to your liking. The intuitive user interface is operated with a navigation wheel and quick buttons, which have been positioned to the right of the drive to make work easier and more efficient. There are 30 programmable work attachment and driver profiles, which ensure that the machine and attachments are used correctly and cost efficiently. The user interface also includes safety functions, such as misuse warnings and maintenance need reminders.

The driver can adjust the functionalities of the work attachment and hydraulics and program the joystick functions. It is also possible to create personal work profiles to increase work efficiency.

The machine features an automatic bucket shape function.

Maintenance

Every Wille machine has been manufactured with great care and professional pride, but this is not where the work ends. The machines require maintenance to ensure consistent performance. We have strived to make it easier to inspect the Wille machines by collecting all components behind one maintenance hatch. It is also easy to inspect the

engine room thanks to the fully removable hood. The hood can be opened even when work attachments are in place.

The user interface provides the driver with a constant stream of information that helps prevent misuse and ensure the long life of the work attachments (and that the regular maintenance is carried out). The user interface reminds the driver of regular maintenance.

Maintenance agreements are also available for the Wille machines to make sure that you always have a well-maintained and functional machine at your disposal. The maintenance is always conducted according to the factory's instructions, using original or corresponding parts and oils. Maximize your machine's performance and resale value with a maintenance agreement. You can also purchase the W-Guard extended warranty for your Wille if you have maintenance agreement for the entire warranty period.

You can easily take all the relevant information and manuals with you in the Wille App. The free app includes the My Wille section in which you can add your own machine with the serial number and view your machine's documents, such as the operating manual, maintenance manual and spare parts list. You can also add your own maintenance location in the app, learn about machines and work attachments in production, and read Wille news.

The Wille smartphone app is available for download in Google Play and App Store.

FIRST-CLASS TECHNOLOGY

The Wille 675Δ and 875Δ have a Stage V 105kW Kohler diesel engine with particulate filter, catalyst and urea system without exhaust gas recirculation. The fuel used can be 100% HVO biodiesel, which significantly decreases the carbon footprint.

AUTOMATIC ECO DRIVE

The machine comes as standard with the Automatic Eco Drive feature, which reduces fuel consumption and noise. It lowers engine speed automatically as needed, saving fuel and reducing emissions.

SMART DRIVE

Smart Drive is a more ergonomic alternative to a creeping pedal. It uses software to convert the accelerator into a drive pedal: you can use the hand throttle to set the engine speed and only use the pedal to adjust the driving speed.

SMART CRUISER

The precise Smart Cruiser cruise control optimised for work use operates using logic similar to a car's cruise control. It makes, for example, ploughing and brushing work easier and makes changing work locations more comfortable.

SMART FLOW

The Smart Flow feature adjusts the output of the motor hydraulics automatically based on machine speed. For example, it keeps the dispensing rate even regardless of varying driving speed during gritting.

SMART LUBE

With the Smart Lube system, which is available as an option, the driver can select the lubrication output of the central lubrication system from four preset settings. Selecting the correct supply rate prevents excessive lubrication.



With the Heavy Duty driving mode, you can make use of all the machine's pulling power, for example when loading and ploughing, and handle even heavy loads nimbly and effortlessly. Due to the optimal load Heavy Duty driving mode saves power transmission parts in the long run.

ACCESSORIES 675Δ 875Δ

- 1. Roller blind
- 2. Waist beacons
- 3. Rear view camera
- 4. 8 pcs LED warning lights
- 5. Special colour
- 6. Armor light
- 7. Storage box for cab
- 8. Double headlights

Additional options include:
heated windscreen,
additional hydraulics,
Eberspächer cab heater,
hydraulic rear lift
and cup holder.

1.

2.

3.

4.

5.

6.

7.

8.

WILLE

675Δ

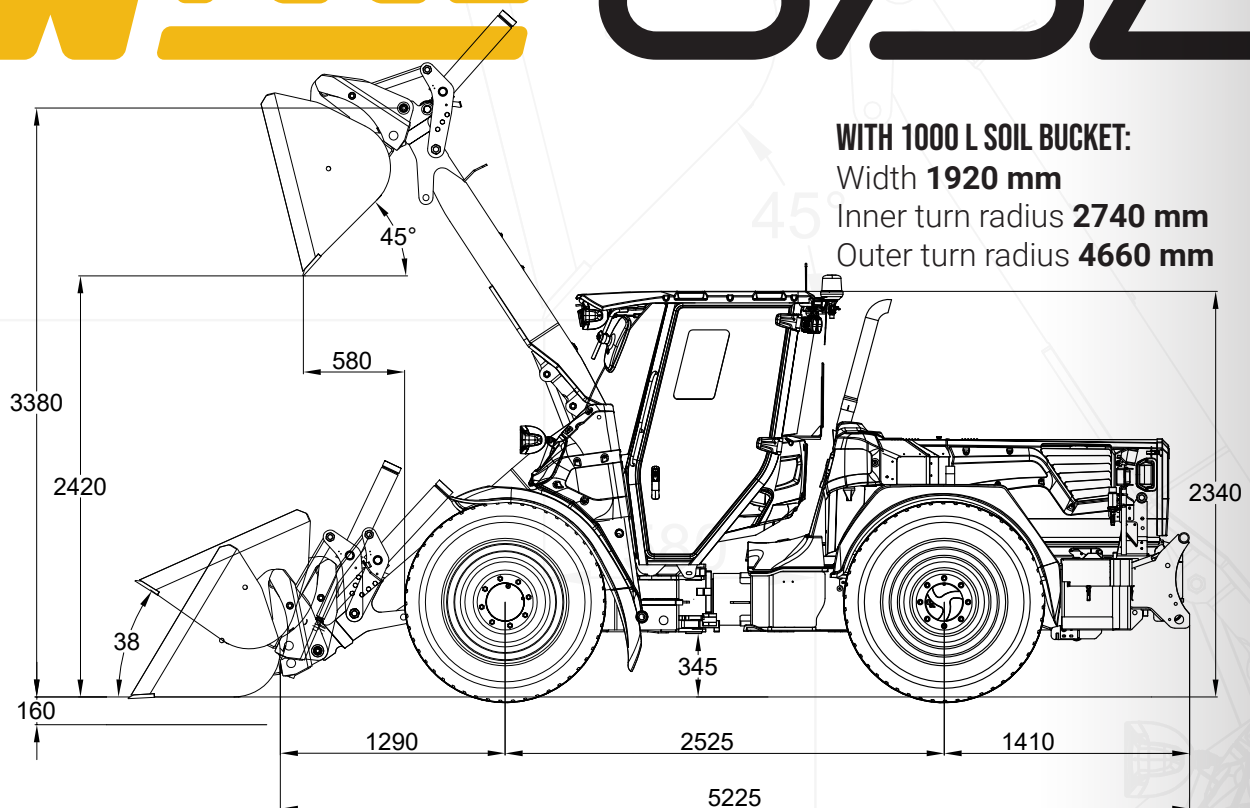

WITH 1000 L SOIL BUCKET:

Width **1920 mm**

Inner turn radius **2740 mm**

Outer turn radius **4660 mm**

ENGINE

- Kohler KDI 3404 TCR-SCR EU Off Road Stage V
- 4 cylinder turbo charged and intercooled diesel engine
- DOC, DPF and SCR (not EGR)
- Common Rail fuel system
- Engine displacement 3359 cm³
- Output 105 kW (143 hv)/2200 r/min
- Max. torque 650 Nm/1400 r/min
- Fuel tank 100 l
- AdBlue tank 16 l

ELECTRIC SYSTEM

- Voltage 12 V
- Electric main switch
- Battery 180 Ah
- Starter motor 3,2 kW
- Charger 120 A

TRANSMISSION

- Hydrostatic, electronically controlled
 - Variable displacement pump
 - Variable displacement motor
- Electrohydraulic steering in both speed ranges
- Driving speed/tractive force
 - 0-20 km/h/5300 daN
 - 0-50 km/h/2250 daN

NOISE LEVEL

- Outside cabin under LwA 103 dBA (ISO 6395:2008)
- Inside cabin under Lpa 70 dBA (ISO 6396:2008)

WEIGHTS

- Total 6100/6500* kg
 - Front axle weight 2330 kg
 - Rear axle weight 3770/4170* kg
- *Liquid-filled rear tires

STEERING SYSTEM

- Hydrostatic articulated frame steering
- Turn angle +/- 39°
- Tilt angle +/- 12,5°

AXLES

- Automatic friction locks in the front and the rear
- Hydraulically assisted multi-disc brakes in oil-bath in the front and the rear
- Automatic parking brake

WORK HYDRAULICS

- Load-detecting variable displacement pump 160 l/min
- Gear pump 50 l/min
- Engine hydraulics maximum output 210 l/min
- Maximum working pressure 240 bar
- Volume of hydraulic system 150 l
- Hydraulic oil cooler

FRONT LOADER

- Quick coupler options: Kunta500, Vila, Volvo BM ja Trima
- Hydraulic work device quick locking
- Hydraulic stabilizer system
- Automatic loader suspension 4-10 km/h
- Electric pre-steering
- Arm maintenance support
- Arm support for bulldozing

TYRES

- 420/65R24 (width of the machine 1920 mm)
- 360/80R20 (width of the machine 1750 mm)

STANDARD EQUIPMENT

- Engine hydraulics (max output 2200 rpm)
 - two-way front 0-160 l/min
 - one-way front 50 l/min
 - one-way front 50-210 l/min
 - one-way rear 50/0-160/50-210 l/min
- Output of the engine hydraulics is shown on the display
- 3rd cylinder hydraulics, propo controlled 0-90 l/min
- 4rd cylinder hydraulics, propo controlled 0-90 l/min
- Dual-acting cylinder hydraulics rear
- Electric inching and accelerator pedal
- Socket outlet of 12 V in the front and the rear
- Lowerable LED warning beacon
- 7" display
- Radio/Bluetooth/AUX-in/USB
- Windscreen and rear window wiper and washer
- Heated rear-view mirrors
- Automatic headlights
- LED work lights in the front and the rear
- Height and depth-adjustable steering wheel
- Seat with heating
- 2-point seatbelt
- Additional rear lights in upper corners of cab
- Programmable work device and driver profiles
- 4 different driving modes: Eco On, Eco Off, Heavy Duty and Smart Drive
- Smart Cruiser cruise control
- Speed adjusted motor hydraulics
- Safety cabin ROPS (ISO 3471)
- Safety cabin FOPS (ISO 3449 1365 J)
- Engine heater
- Hydraulic oil heater
- Bottom plates in the front and the rear
- Tow hitch
- Reverse alarm (can be connected on/off by operator)
- Brackets for work attachments on top of the engine compartment

OPTIONAL EQUIPMENT

- Hydraulic rear lift with tow hitch (kunta500, Vila, Volvo BM and Trima)
 - lifting force to upper position 34 kN
 - downward force with hydraulic rear blade 17,7 kN
 - floating position
- 5rd cylinder hydraulics
- 6rd cylinder hydraulics
- Smart Lube central lubrication
- Air-conditioning, automatic
- Air-cushioned seat, 3-point seatbelt
- Readiness for cabin heater
- Storage box for cab
- Rear view camera
- 2 + 2 LED additional work lights
- 8 pcs LED warning lights
- 4 pcs LED waist beacons
- Trailer brake valve
- Front armor light
- Headlights to the cabin roof line or double headlights
- Multifaster
- Raised cabin 80 mm
- Special color
- Programmable joystick and fast steering
- Immobiliser
- Eberspächer fuel heater
- Anti-Theft System
- Roller blind
- Accessory bar
- Cup holder
- Heated windscreen

WILLE OPTIM WORK ATTACHMENTS

- Rotary brush 240, 270, 320
- Collecting sweeper 650
- Soil bucket 1000 l
- Snow bucket 1900 l
- Multi-function bucket 1500 l
- Leaf bucket 1900 l
- Hydraulic rear blade 2500
- Rear sand spreader 550 l
- High-pressure washer 1500 l
- Hydraulic platform 800 l
- Forklift fork
- Access platform Wille 9

	Front face of the quick coupler	Soil bucket 1000 L	Forklift fork with 500 mm distance to center of gravity
Hydraulic lifting force, bottom position kN	50,0	45,2	42,1
Hydraulic lifting force, top position kN	34,7	27,7	26,0
Rated transport capacity kg		1925* 2155**	2365 (even surface*) 2640 (even surface**)
Tipping load with straight/turned machine kg	5050/4290*	4590/3850*	3510/2960*
	5610/4760**	5140/4310**	3920/3300**
Break-out force of the bucket kN		46,2	

*With NOKIAN Tyres 420/65R24 and rear lift without counterweight

**With liquid-filled rear tires and rear lift

WILLE 875Δ

WITH 1300 L SOIL BUCKET:

Width **2130 mm**

Inner turn radius **2855 mm**

Outer turn radius **4985 mm**

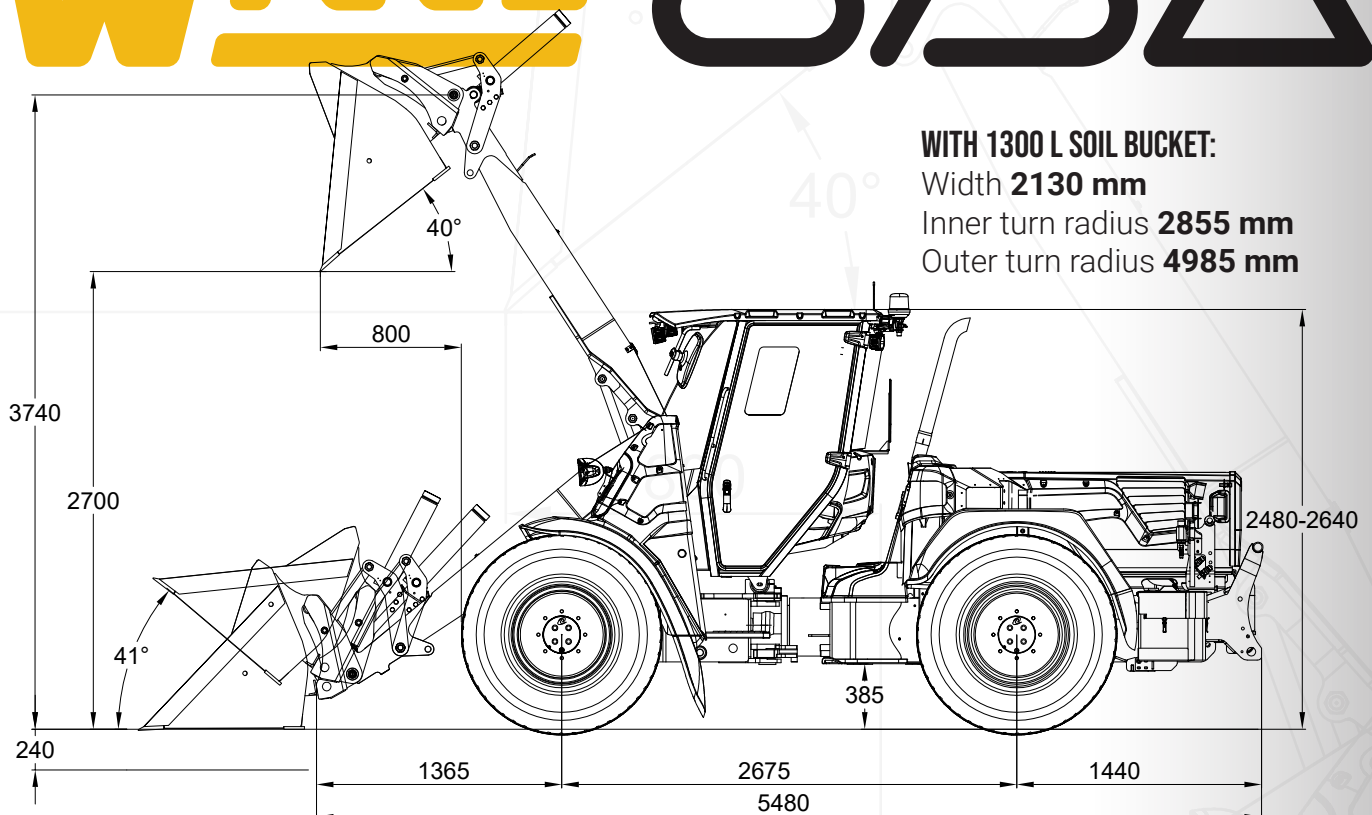

ENGINE

- Kohler KDI 3404 TCR-SCR EU Off Road Stage V
- 4 cylinder turbo charged and intercooled diesel engine
- DOC, DPF and SCR (not EGR)
- Common Rail fuel system
- Engine displacement 3359 cm³
- Output 105 kW (143 hp)/2200 r/min
- Max. torque 650 Nm/1400 r/min
- Fuel tank 100 l
- AdBlue tank 16 l

ELECTRIC SYSTEM

- Voltage 12 V
- Electric main switch
- Battery 180 Ah
- Starter motor 3,2 kW
- Charger 120 A

TRANSMISSION

- Hydrostatic, electronically controlled
 - Variable displacement pump
 - Variable displacement motor
- Electrohydraulic steering in both speed ranges
- Driving speed/tractive force
 - 0-20 km/h/5100 daN
 - 0-50 km/h/2250 daN

NOISE LEVEL

- Outside cabin under LwA 103 dBA (ISO 6395:2008)
- Inside cabin under Lpa 69 dBA (ISO 6396:2008)

WEIGHTS

- Total 7070/7570* kg
 - Front axle weight 2880 kg
 - Rear axle weight 4190/4690* kg
- *Liquid-filled rear tires

STEERING SYSTEM

- Hydrostatic articulated frame steering
- Turn angle +/- 39°
- Tilt angle +/- 12,5°

AXLES

- Automatic friction locks in the front and the rear
- Hydraulically assisted multi-disc brakes in oil-bath in the front and the rear
- Automatic parking brake

WORK HYDRAULICS

- Load-detecting variable displacement pump 160 l/min
- Gear pump 50 l/min
- Engine hydraulics maximum output 210 l/min
- Maximum working pressure 240 bar
- Volume of hydraulic system 150 l
- Hydraulic oil cooler

FRONT LOADER

- Quick coupler options: Kunta500, Volvo BM
- Hydraulic work device quick locking
- Hydraulic stabilizer system
- Automatic loader suspension 4-10 km/h
- Electric pre-steering
- Arm maintenance support
- Arm support for bulldozing

TYRES

- 460/65R24 (width of the machine 2130 mm)
- 500/60R22,5 (width of the machine 2150 mm)

STANDARD EQUIPMENT

- Engine hydraulics (max output 2200 rpm)
 - two-way front 0-160 l/min
 - one-way front 50 l/min
 - one-way front 50-210 l/min
 - one-way rear 50/0-160/50-210 l/min
- Output of the engine hydraulics is shown on the display
- 3rd cylinder hydraulics, propo controlled 0-90 l/min
- 4rd cylinder hydraulics, propo controlled 0-90 l/min
- Double-acting cylinder hydraulics to the rear
- Electric inching and accelerator pedal
- Socket outlet of 12 V in the front and the rear
- Lowerable LED warning beacon
- 7" display
- Radio/Bluetooth/AUX-in/USB
- Windscreen and rear window wiper and washer
- Heated rear-view mirrors
- Automatic headlights
- LED work lights in the front and the rear
- Height and depth-adjustable steering wheel
- Seat with heating
- 2-point seatbelt
- Additional rear lights in upper corners of cab
- Programmable work device and driver profiles
- 4 different driving modes: Eco On, Eco Off, Heavy Duty and Smart Drive
- Smart Cruiser cruise control
- Speed adjusted motor hydraulics
- Safety cabin ROPS (ISO 3471)
- Safety cabin FOPS (ISO 3449 1365 J)
- Engine heater
- Hydraulic oil heater
- Bottom armours in the front and the rear
- Tow hitch
- Reverse alarm (can be connected on/off by operator)
- Brackets for work attachments on top of the engine compartment

OPTIONAL EQUIPMENT

- Hydraulic rear lift with tow hitch (kunta500, Volvo BM)
 - lifting force to upper position 34 kN
 - downward force with hydraulic rear blade 17,7 kN
 - floating position
- 5rd cylinder hydraulics
- 6rd cylinder hydraulics
- Smart Lube central lubrication
- Air-conditioning, automatic
- Air-cushioned seat, 3-point seatbelt
- Readiness for cabin heater
- Storage box for cab
- Rear view camera
- 2 + 2 LED additional work lights
- 8 pcs LED warning lights
- 4 pcs LED waist beacons
- Trailer brake valve
- Front armor light
- Headlights to the cabin roof line or double headlights
- Multifaster
- Raised cabin 160 mm
- Special color
- Programmable joystick and fast steering
- Immobiliser
- Eberspächer fuel heater
- Anti-Theft System
- Roller blind
- Accessory bar
- Cup holder
- Heated windscreen

WILLE OPTIM WORK ATTACHMENTS

- Rotary brush 240, 270, 320
- Collecting sweeper 650
- Soil bucket 1000 l
- Snow bucket 2500 l
- Multi-function bucket 2000 l
- Leaf bucket 1900 l
- Hydraulic rear blade 2500
- Rear sand spreader 700 l
- High-pressure washer 1500 l
- Hydraulic platform 800 l
- Forklift fork
- Access platform Wille 9

	Front face of the quick coupler	Soil bucket 1300 L	Forklift fork with 500 mm distance to center of gravity
Hydraulic lifting force, bottom position kN	71,4	67,0	56,7
Hydraulic lifting force, top position kN	46,1	43,2	36,1
Rated transport capacity kg		2135 * 2350 **	2780 (even surface*) 3120 (even surface**)
Tipping load with straight/turned machine kg	5540/4910 * 6040/5230 **	4900/4270 * 5400/4700 **	4070/3480 * 4570/3900 **
Break-out force of the bucket kN		50,5	

*With NOKIAN Tyres 420/65R24 and rear lift without counterweight

**With liquid-filled rear tires and rear lift

10 REASONS TO CHOOSE WILLE

1. Efficient year-round operation
2. Quiet, spacious and ergonomic cab
3. 4 different driving modes to choose from: Eco, Eco off, Heavy and Smart
4. Versatile and powerful hydraulics
5. Clear and intuitive user interface
6. Modifiable to suit every application and driver
7. Easy maintenance
8. Multi-function Smart Cruiser cruise control
9. Functions to assist the driver
10. Appearance can be modified to match your branding

We reserve the right to errors and technical changes.

READ MORE:

WWW.WILLEMACHINES.COM

WILLE

WILLE DEALERS NEAR YOU:

>> www.willemachines.com



WilleMachines.com





Wille 875 MTE: The Ultimate Airport Maintenance Solution

Engineered for precision and efficiency, the Wille 875 MTE is the premier choice for year-round airport maintenance.

1

FEATURES:

Robust Performance: Powerful engine and advanced hydraulics.

Year-Round Utility: Adaptable with specialized attachments.

Rapid Runway Clearing: Ensures minimal downtime during snowstorms and adverse weather conditions.

Multi-Season Use: Equipped for year-round airport maintenance tasks.

2

ATTACHMENTS:

16' UPlow: Efficient snow removal with a wide 16' reach. Quickly clears runways and taxiways, minimizing downtime during snowstorms.

13' Rotary Broom: Ideal for sweeping snow, debris, and dirt from surfaces. Ensures runways and taxiways remain clean and safe, enhancing visibility and safety for aircraft operations.

Cold Airblast: Uses powerful jets to clear snow and ice without chemicals.

Material Spreader: Precision spreading of deicing materials.

